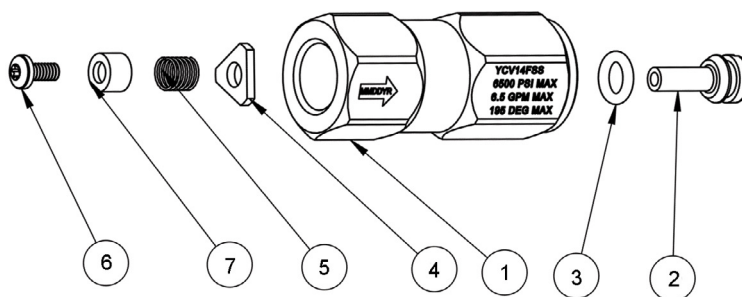

**GENERAL PUMP** *A member of the Interpump Group***FEATURES**

- Light Cracking Pressure
- Stainless Body with Stainless Wetted Parts
- Hard PTFE o-ring for harsh chemical applicaiton
- Solid Body Construction, Won't Come Apart During Installation

**SPECIFICATIONS**

Part Number	YCV14FSSL
Body Material	Stainless Steel
Max Volume	6.5 GPM
Max Discharge Pressure	6,500 PSI
Max Fluid Temperature	195° F
Port Sizes	1/4" NPT
Cracking Pressure	0.5 PSI
Shipping Weight	.5 lbs
Length	1.85"

**PARTS LIST**

No.	Part No.	Description	Qty.
1	520239	Body, Checkvalve	1
2	520235	Piston, Checkvalve	1
3	701009PTFE	O-ring, PTFE	1
4	540081	Retainer	1
5	720074	Spring	1
6	201008	Screw, 4-40 UNC, T8,	1
7	520347	Spring Stop	1



WARNING: This product can expose you to chemicals including lead, which is known to the state of California to cause cancer and birth defects or other reproductive harm. For more information, go to [www.P65Warnings.ca.gov](http://www.P65Warnings.ca.gov)

**WARNING: High Pressure Systems require a primary pressure regulating device (i.e. regulator, unloader) and a secondary pressure relief device (i.e. pop-off valve, relief valve). Failure to install such relief devices properly could result in personal injury or damage to pump or property. GP does not assume any liability or responsibility for the operation of the user's high pressure system.**



General Pump  
is a member of  
the Interpump Group



**GENERAL PUMP** 1174 Northland Drive • Mendota Heights, MN 55120  
Phone: 651.686.2199 • Fax: 800.535-1745 • e-mail: [sales@gpcompanies.com](mailto:sales@gpcompanies.com) • [www.generalpump.com](http://www.generalpump.com)

Ref 301177 Rev. A  
04-25

