

**GENERAL PUMP** *A member of the Interpump Group*

# D30001/2/4/6

## Hose Reels



### SPECIFICATIONS

PART NUMBER	D30001	D30002	D30004	D30006
3/8" Hose Capacity	50 ft.	100 ft.	150 ft.	200 ft.
Swivel Pressure Rating	4000 PSI			
Inlet	3/8" NPT-F			
Outlet	3/8" NPT-F			
Max. Temp	225° F			

### FEATURES / BENEFITS

- Direct hand-crank rewind with locking pin
- Durable powdercoated finish
- Solid steel construction
- Full flow swivel brass joint

### DIMENSIONS (in/mm)

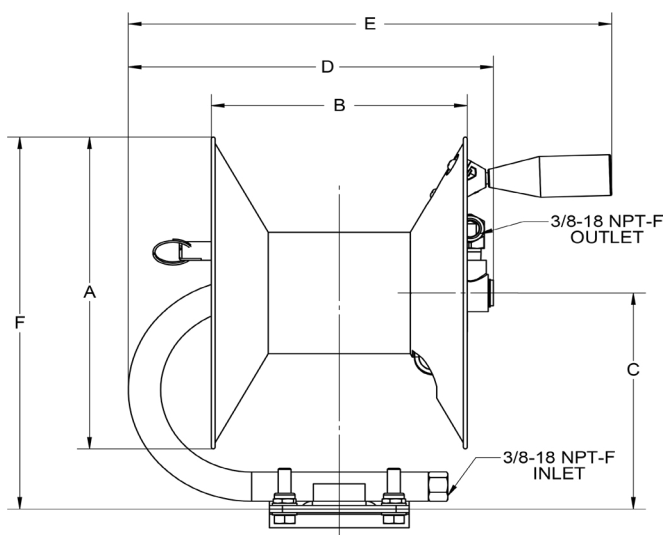

	Dimensions (in/mm)					
	A	B	C	D	E	F
D30001	10.5/267	7.8/198	7.3/185	11.1/282	14.7/374	15.5/319
D30002	10.5/267	11.7/298	7.3/185	15.0/382	18.7/474	12.5/319
D30004	13.4/340	10.1/257	9.5/243	14.3/364	18.0/456	16.2/412
D30006	13.4/340	12.3/312	9.5/243	16.5/416	20.1/511	16.4/412

### PARTS LIST

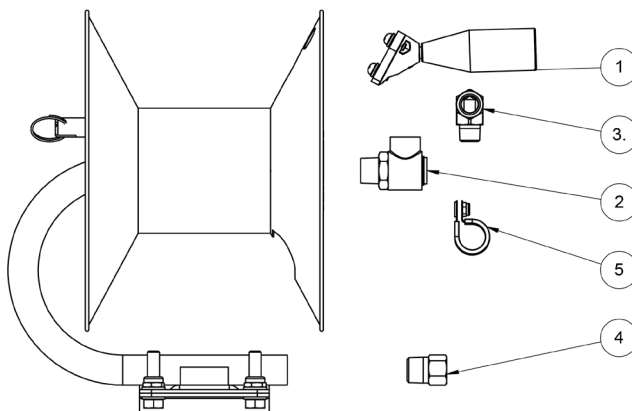

	Item				
	1	2	3	4	5
D30001	2100043	2103241	D10116	2530112	2103237
D30002					
D30004					
D30006					
2100278	Repair kit for 2103241				
2100530	Lock pin repair kit				

### ASSEMBLY INSTRUCTIONS

1. Connect the handle to the flange. Nuts go on the handle side of the flange.
2. Use (4) 3/8" or 10 mm bolts when securing the hose reel to the ceiling or wall.
3. Use the provided nuts, bolts and mounting bracket when securing the hose reel to a cart.
4. Use thread sealant (not provided) on inlet threads and outlet hose (not provided).
5. Connect the supply hose from the pressure washer unit to the inlet bushing on the base of the hose reel.
6. Feed the discharge hose through the opening in the flange of the hose reel and connect to the outlet elbow.
7. Clamp the hose grip to the hose on the extended stud in the opening of the flange and tighten down with nut and washer.
8. The hose reel is ready for operation.

### SAFETY PRECAUTIONS

1. Make sure incoming pressure does not exceed the rated pressure.
2. Use proper eye protection when assembling and using the hose reel.
3. Assemble the hose reel on a clean workbench free of debris and moisture.
4. Use soap and water when checking for air leaks.
5. Keep children away from work area.

**WARNING:** High Pressure Systems require a primary pressure regulating device (i.e. regulator, unloader) and a secondary pressure relief device (i.e. pop-off valve, relief valve). Failure to install such relief devices properly could result in personal injury or damage to pump or property. GP does not assume any liability or responsibility for the operation of the user's high pressure system.

#### **WARNING!**

*Exposure of skin directly to pressurized air or fluids could result in severe bodily injury!*



WARNING: This product can expose you to chemicals including lead, which is known to the state of California to cause cancer and birth defects or other reproductive harm. For more information, go to [www.P65Warnings.ca.gov](http://www.P65Warnings.ca.gov)