

GENERAL PUMP *A member of the Interpump Group*

2103410

Electric Hose Reel Motor Kit



2103410 Shown on
DHRA50150

SPECIFICATIONS

PART NUMBER	2103410*
Voltage	12V DC
Weight	21 lbs.
*Hose reel sold separately	

Assembled power rewind kits available

- A5015012 - DHRA50150 assembled with 2103410
- A5030012 - DHRA50300 assembled with 2103410
- A5045012 - DHRA50450 assembled with 2103410

FEATURES / BENEFITS

- Allows for effortless rewinding of hose
- Free spin allows for easy pulling out of hose
- Durable powdercoated finish
- Stainless steel hardware
- Long lasting hardened gears
- Fits all DHRA hose reels

DIMENSIONS (in/mm)

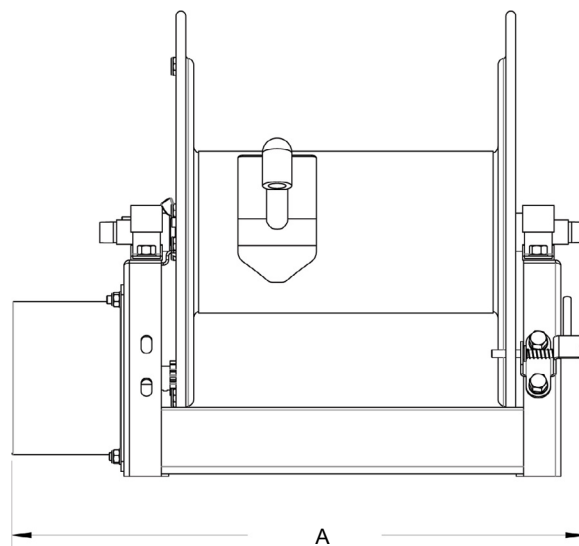
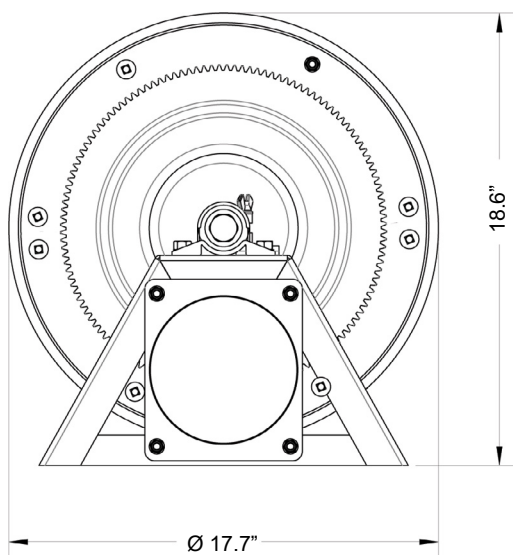

Hose Reel	"A" Dimensions
DHRA50150	18"
DHRA50300	23"
DHRA50450	29"



General Pump
is a member of
the Interpump Group

Ref 310136 Rev H
03-25



RING GEAR INSTALLATION



1. Engage the pin lock and mark how far it sticks out from the flange for alignment.



2. Remove the bolts and nuts of the pillow block bearings. (17MM or 11/16") Do not remove the set screw.



3. Lift the flange from the frame on the opposite side of the pin lock (same side as the adjustable brake) and fit the ring gear onto the flange.

4. Reassemble pillow block bearings and line up the flange with the mark on the pin lock when tightening down to proper alignment. Torque to 250 in-lbs.



5. Assemble ring gear to the hose reel using carriage bolts, washers, and lock nuts. (13MM or 1/2") Torque to 250 in-lbs.

6. Rotate the hose reel 360° to verify proper alignment (flange does not rub against frame) and pin lock engagement (fits correctly in flange slots).

Electric Hose Reel Motor Kit

MOTOR INSTALLATION



1. Slide spur gear onto the motor shaft; the gear face will hang over the end of the motor shaft by about 5 mm (3/16"). Line up the motor to the hose reel to verify spur gear engages the ring gear and does not rub against the flange.

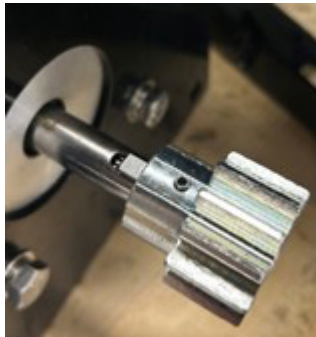

2. Apply a drop of medium-strength thread locker to the set screw and thread into gear. Torque set screw to 40 in-lb



3. Attach the motor assembly to the hose reel frame using carriage bolts, M12 flat washers (bottom two bolts only), M10 flat washers, and locknuts. For now, apply only a small amount of force until it feels snug, but not fully tightened.

4. Rotate the hose reel by hand a few revolutions to get the motor assembly and ring gears to align. Torque the motor assembly nuts to 250 in-lb.

ACCESSORIES

DMC12V: 12 Volt DC Variable Speed Controller Rewind Kit



- 30 amp auto-reset circuit breaker
- Heavy duty momentary on/off switch
- Variable speed knob with built in on/off function
- LED power indicator light
- Reversible powder-coated mounting plate for left or right orientation
- Sealed Housing

Part Number	DMC12V
Voltage	12 VDC
Max Amps	30 A
Working Temperature	-4°F - 104°F

SAFETY PRECAUTIONS

1. Make sure incoming pressure does not exceed the rated pressure.
2. Use proper eye protection when assembling and using the hose reel.
3. Assemble the hose reel on a clean workbench free of debris and moisture.
4. Use soap and water when checking for air leaks.
5. Keep children away from work area.

WARNING!

Exposure of skin directly to pressurized air or fluids could result in severe bodily injury!

WARNING: High Pressure Systems require a primary pressure regulating device (i.e. regulator, unloader) and a secondary pressure relief device (i.e. pop-off valve, relief valve). Failure to install such relief devices properly could result in personal injury or damage to pump or property. GP does not assume any liability or responsibility for the operation of the user's high pressure system.



WARNING: This product can expose you to chemicals including lead, which is known to the state of California to cause cancer and birth defects or other reproductive harm. For more information, go to www.P65Warnings.ca.gov