

GENERAL PUMP*A member of the Interpump Group***100976/100977****Clutches For 24mm Solid Shaft Pump**

Typical Mobile Clutch - Water Pump Applications In typical water pump applications, the clutch is mounted on the input shaft of the water pump. Since the clutch has an integral pulley, a belt is used as the input to the clutch. This belt is normally driven directly from an electric motor or a gas/diesel engine. When there is no power to the clutch, the water pump does not engage; however when power is activated, the clutch drives the water pump to initiate water flow. In this application, the GP clutch is mounted directly to a General Pump by using an adapter plate.

Used in Carpet Cleaning, Texture Spray Machines, High Pressure Pump applications.

SPECIFICATIONS

Pulley Size & Type:	12.4" Pitch - B Groove, 24mm Shaft	
Static Torque	Initial Torque:	80 Nm (59 Ft.lbs.)
	Final Torque:	237 Nm (175 Ft. lbs.)
Power Requirement:	12V	50 Watts
Weight:	100976	31.0 lbs.
	100977	24.0 lbs.

Part Number	Description	
100976	Clutch w/Mounting Plate	47 and 66 Series, 12V, Dual Groove, 12.4" Pulley
100977	Clutch w/Mounting Plate	47 and 66 Series, 12V, Single Groove, 12.4" Pulley
NOTE: This clutch kit to be used with tapped crankshafts only.		

Reasons for using an Electromagnetic Clutch

- Extended pump life
- Less Cost
- Simple installation
- Operator convenience
- Cold weather starting

General Pump Mobile Clutch Design Advantages

- **Solid forged rotor.** A one-piece solid forged rotor means no chance of internal parts separation. They have an even wall thickness around the coil which gives optimum flux distribution, maximizing torque.
- **High temperature, longer-life grease.** Our special long-life grease has shown a significant improvement in life over other standard high temp greases.
- **E-coating.** Where possible, all parts in the clutch are e-coated to give maximum corrosion protection.
- **High-temperature epoxy coil.** To help prevent failure from vibration and outside contaminants, all coils are sealed in the coil shell with a high-temperature epoxy coating.
- **Forged machined pulley.** All GP models use a heavy-duty machined pulley. A stronger pulley resists damage due to abusive environments.
- **Clutches are also available mounted on a General Pump. Please contact your sales representative.**



General Pump
is a member of
the Interpump Group

Ref 300730 Rev. B
02-12



100976 / 100977

For 24mm Solid Shaft Pump

GENERAL PUMP

A member of the Interpump Group

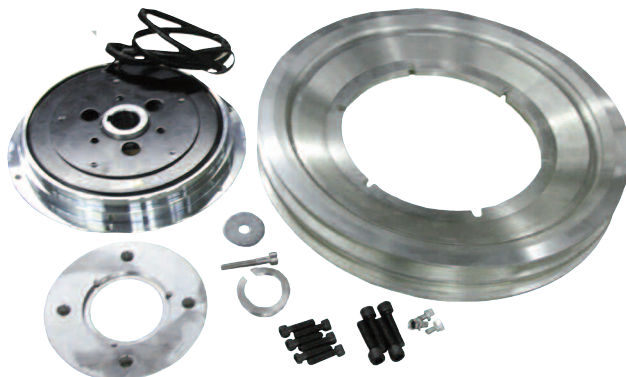

100976 PARTS LIST

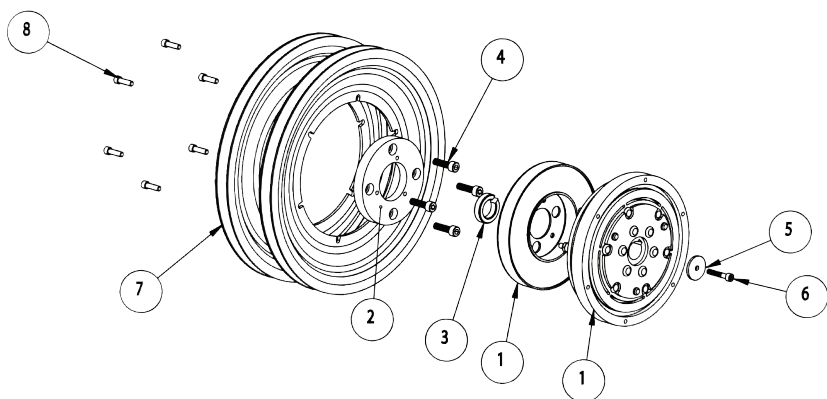

Item	Part #	Description	QTY
1	103097	Clutch	1
2	500014	Mounting Plate	1
3	500015	Shaft Spacer	1
4	200059	SHCS, M8, 1.25x25mm	4
5	203002	Washer, .25x1.25x.125	1
6	200026	SCHS, M6, 1.0x35mm	1
7	540055	Pulley	2
8	201021	SHCS, 1/4-20x1/8"	6

100977 PARTS LIST

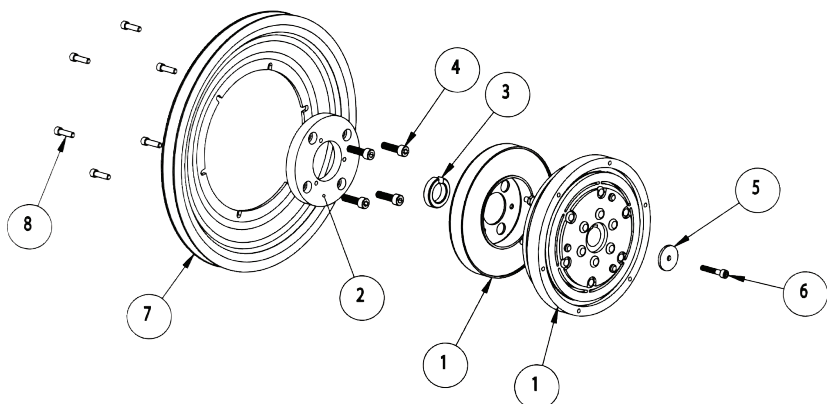

Item	Part #	Description	QTY
1	103097	Clutch	1
2	500014	Mounting Plate	1
3	500015	Shaft Spacer	1
4	200059	SHCS, M8, 1.25x25mm	4
5	203002	Washer, .25x1.25x.125	1
6	200026	SCHS, M6, 1.0x35mm	1
7	540055	Pulley	1
8	201021	SHCS, 1/4-20x1/8"	6