

Pump Thermal Protectors

Protects the pump from damaging heat build-up while it is in bypass mode. The thermal relief valve, sensing a rise in temperature, opens and discharges a small amount of heated fluid. This allows cooler water to enter the system and cool the pump. When the gun is discharged the cooler water will cause the valve to close immediately.

FEATURES/BENEFITS

- Most consistent temperature range on the market
- Quickest response to rising temperature
- Less stress on pump
- Most cost effective thermal protector in the market
- Mounts easily in the pump inlet, supply lines or bypass loop

SPECIFICATIONS

| Part No. | Temperature | Size |
|-----------------|--------------------------------------|----------|
| 100556 | 145° F | 1/4" NPT |
| 100557 | 145° F | 3/8" NPT |
| 100558 | 145° F | 1/2" NPT |
| Hose Barb: | 90°, 1/4" | |
| Pressure Range: | 10 - 90 PSI | |
| Weight: | 1.5 oz | |
| Dimensions: | 1-1/2" H x 1" W | |
| Materials: | Brass, Buna, Delrin, Stainless Steel | |

* Activation temperature varies with system pressure.

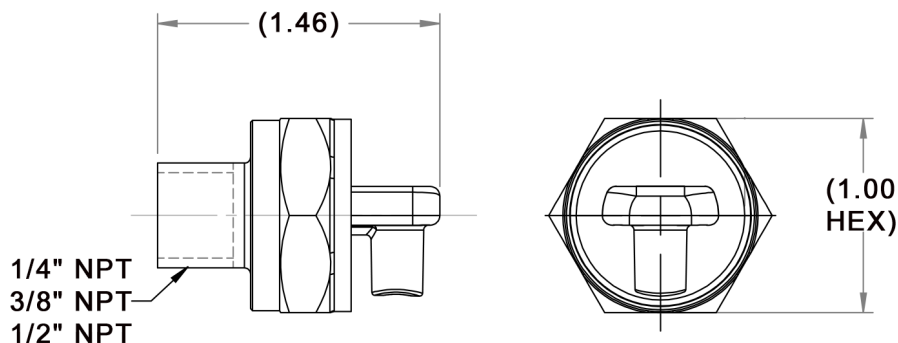
DIMENSIONS

General Pump
is a member of
the Interpump Group



Ref 300963 Rev D
01-20

