

**SPECIFICATIONS**



Part Number:	A7S
Max Volume	45 GPM
Max Pressure	4750 PSI
Setting Pressure	60% of the working pressure upon requests
Inlet	1/2" BSP-M
Shell Material	Forged Steel
Bladder Material	Nitrile Rubber

**DIMENSIONS & INFORMATION**

Dimensions			
A	B	C	D
8.66 in/220 mm	5.12 in/130 mm	1/2"	5/8" UNF

Optional Adapters	
680102	Hex Nipple, 1/2" BSPP-M x 1/2" NPT-M, Zinc Steel
639385	Hex Adapter, 1/2" BSPP-M x 1/2" NPT-F ,Zinc Steel
680110	Seal Ring, 1/2" , Zinc Steel

Recharge Kit	
190417	Includes 100038 Kit, 680135 Fitting (5/8" UNF x Shrader)

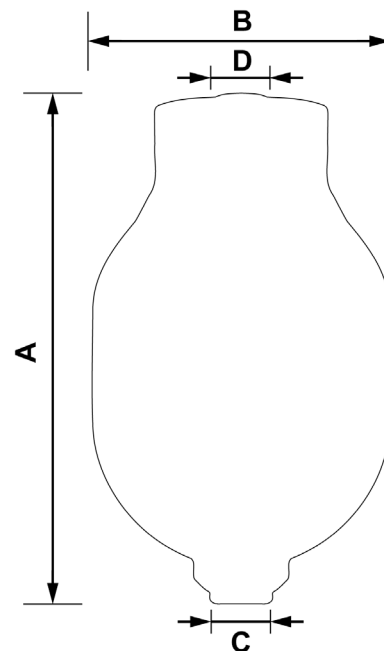

**WARNING: High Pressure Systems require a primary pressure regulating device (i.e. regulator, unloader) and a secondary pressure relief device (i.e. pop-off valve, relief valve). Failure to install such relief devices properly could result in personal injury or damage to pump or property. GP does not assume any liability or responsibility for the operation of the user's high pressure system.**



General Pump is a member of the Interpump Group



WARNING: This product can expose you to chemicals including lead, which is known to the state of California to cause cancer and birth defects or other reproductive harm. For more information, go to [www.P65Warnings.ca.gov](http://www.P65Warnings.ca.gov)

